

ET6x D-clip

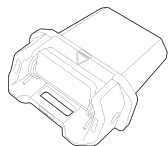

IMPORTANT: To install the Soft Handle or Shoulder Strap, the ET60/ET65 D-Clips are required. The D-Clips, Soft Handle, and Shoulder Strap are each sold separately.



D-clips (x2)

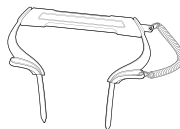

Soft Handle



Shoulder Strap



Buckles (x2)

Installation Guide



MN-004789-01EN-P



ZEBRA

② Attaching the Soft Handle

1. Feed Soft Handle strap through buckle.
2. Feed the Soft Handle strap through D-Clip.
3. Feed the Soft Handle strap through buckle.

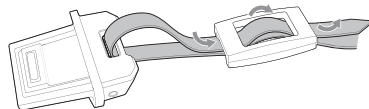
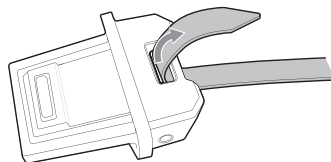

4. Insert D-Clips into tablet.

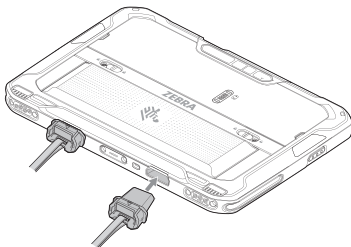

Attaching Shoulder Strap to Soft Handle

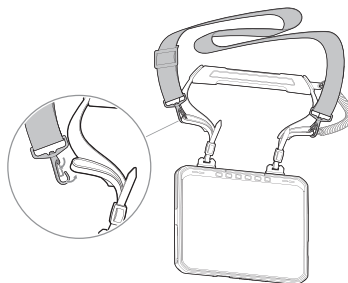
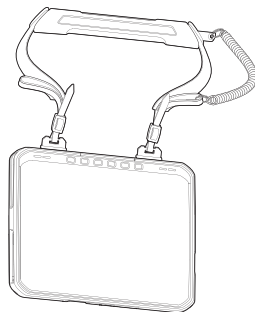

③ Attaching the Shoulder Strap

1. Feed the small strap through buckle.



2. Feed the small strap through D-Clip.

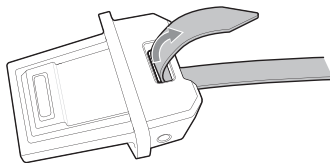

3. Feed the small strap through buckle.

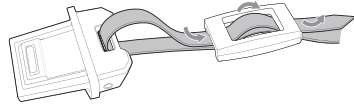

4. Insert D-Clips into tablet.

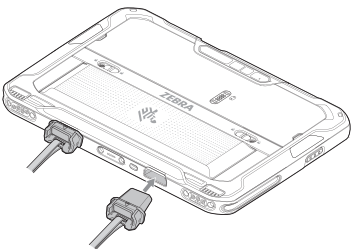

④ Removing D-clip

Lift release latch and pull up.

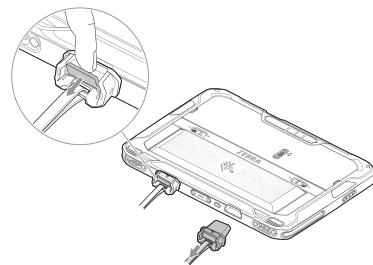
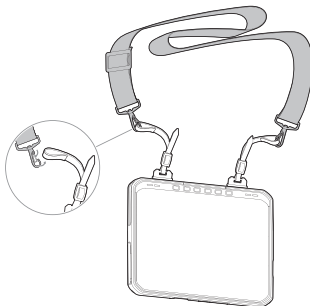

Support and information



Contact Zebra.
zebra.com/contactsupport



View Quick Answers and Knowledge Base.
zebra.com/knowledge



Zebra Technologies | 3 Overlook Point | Lincolnshire, IL 60069 USA
zebra.com
ZEBRA and the stylized Zebra head are trademarks of Zebra Technologies Corp., registered in many jurisdictions worldwide.
All other trademarks are the property of their respective owners.
© 2023 Zebra Technologies Corp. and/or its affiliates. All rights reserved.



Learn about product patent information.
ip.zebra.com



Join Community Connection
of Zebra users and ambassadors.
zebra.com/supportcommunity

